

pompa finale - serie XV

POMPA FINALE ACCOPPIABILE CON XV2
BASE Ø36,5 FEMMINA

XOF-2

X 0 F 06 42 G B B A

Serie	X	serie XV
Gruppo	0	gruppo 0
Categoria	F	pompa finale
Cilindrata	06	0.76
Base	42	Ø36.5 femmina rotazione destra 2P+0P, 3P+0P
Albero	G	CI001 - Finale per 1+0, 2+0
Corpo	IN	aspirazione - 1/4" BSP
	OUT	mandata - 1/4" BSP
Coperchio	A	standard

X2T
X2I-2
X3T
X3I-3

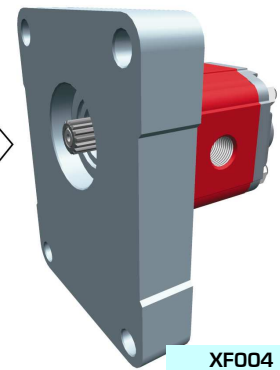

XF004

Tabella dati tecnici

TIPO	Cilindrata cm3/giro	Pressione Max.		CODICE																	
		P1 bar	P3 bar	Rotazione Sinistra		Rotazione destra															
				X	0	F	X	0	F												
XOF-2/0.17	0,16	220	260	X	0	F	01	41	G	B	B	A	X	0	F	01	42	G	B	B	A
XOF-2/0.25	0,24	220	260	X	0	F	02	41	G	B	B	A	X	0	F	02	42	G	B	B	A
XOF-2/0.45	0,45	220	280	X	0	F	04	41	G	B	B	A	X	0	F	04	42	G	B	B	A
XOF-2/0.57	0,56	220	280	X	0	F	05	41	G	B	B	A	X	0	F	05	42	G	B	B	A
XOF-2/0.76	0,75	220	280	X	0	F	06	41	G	B	B	A	X	0	F	06	42	G	B	B	A
XOF-2/0.98	0,92	220	280	X	0	F	07	41	G	B	B	A	X	0	F	07	42	G	B	B	A
XOF-2/1.27	1,26	220	280	X	0	F	09	41	G	B	B	A	X	0	F	09	42	G	B	B	A
XOF-2/1.52	1,48	220	280	X	0	F	11	41	G	B	B	A	X	0	F	11	42	G	B	B	A
XOF-2/2.30	2,28	190	210	X	0	F	13	41	G	B	B	A	X	0	F	13	42	G	B	B	A

P1) Pressione max. di esercizio - P3) Pressione max. di picco

Per applicazioni gravose si consiglia di verificare la coppia ammissibile dell'albero

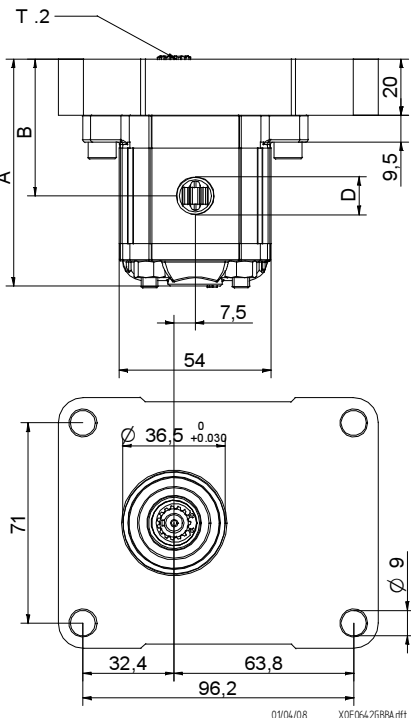
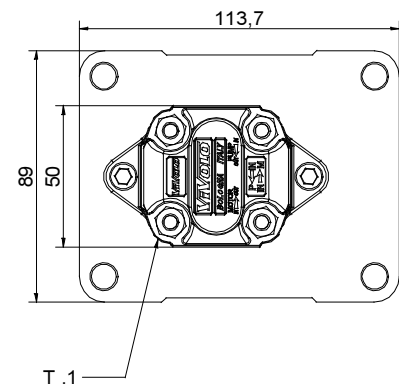

T.1 = 11.7÷13.7 [Nm] - coppia di serraggio viti M6



T.2 = 2.1 [Nm] - coppia ammissibile dell'albero (N.B. Per la scelta dell'albero verificare sempre la coppia ammissibile).

Tavola delle varianti

XOF-2

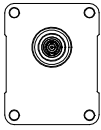
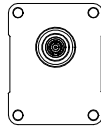
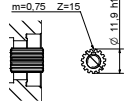
BASE ø36,5 Femmina

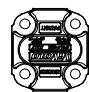
BASE ø36,5 Femmina		Albero	
Rotazione Sinistra	Rotazione destra		
	41		42
		C1001 - Cilindrico T.2 = 2.1 [Nm] 	G

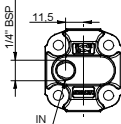
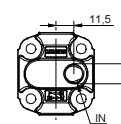
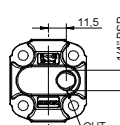
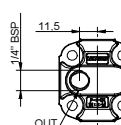
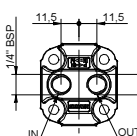
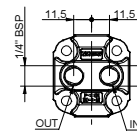
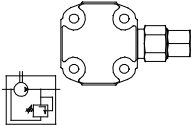
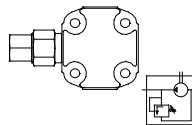
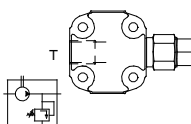
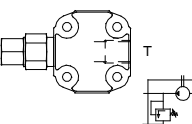
Coperchio		
Rotazione Sinistra	Rotazione destra	
		A
		B
		C
		D
		N
Drenaggio interno		
		O
Drenaggio esterno		

Cilindrata	
TIPO	CODICE
XOF-2/0.17	01
XOF-2/0.25	02
XOF-2/0.45	04
XOF-2/0.57	05
XOF-2/0.76	06
XOF-2/0.98	07
XOF-2/1.27	09
XOF-2/1.52	11
XOF-2/2.30	13

Corpi standard				
Cilindrata	cm3/giro	Filettature standard		
		B - B	Z - B	Z - Z
0.17		B - B	Z - B	Z - Z
0.25		B - B	Z - B	Z - Z
0.45		B - B	Z - B	Z - Z
0.57		B - B	Z - B	Z - Z
0.76		B - B	Z - B	Z - Z
0.98		B - B	Z - B	Z - Z
1.27		B - B	Z - B	Z - Z
1.52		B - B	Z - B	Z - Z
2.30		B - B	Z - B	Z - Z

Tabella con indicate le combinazioni delle flangiate e filettature standard disponibili a magazzino

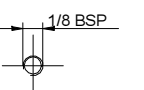
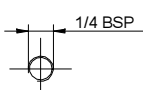
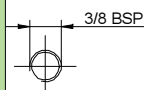
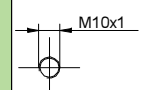
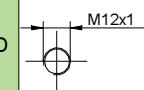
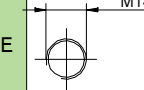
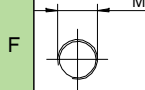
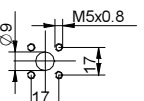
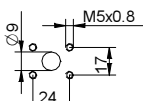
Corpo (filettature e flangiate)													
	A		B		C		D		E		F		G
	H		I	Corpo Chiuso		Z							